

Notes: .01 Contractor is responsible for site verifications of all dimensions
 .02 Drawings are not to be scaled for estimating purposes
 .03 All areas given are approximate

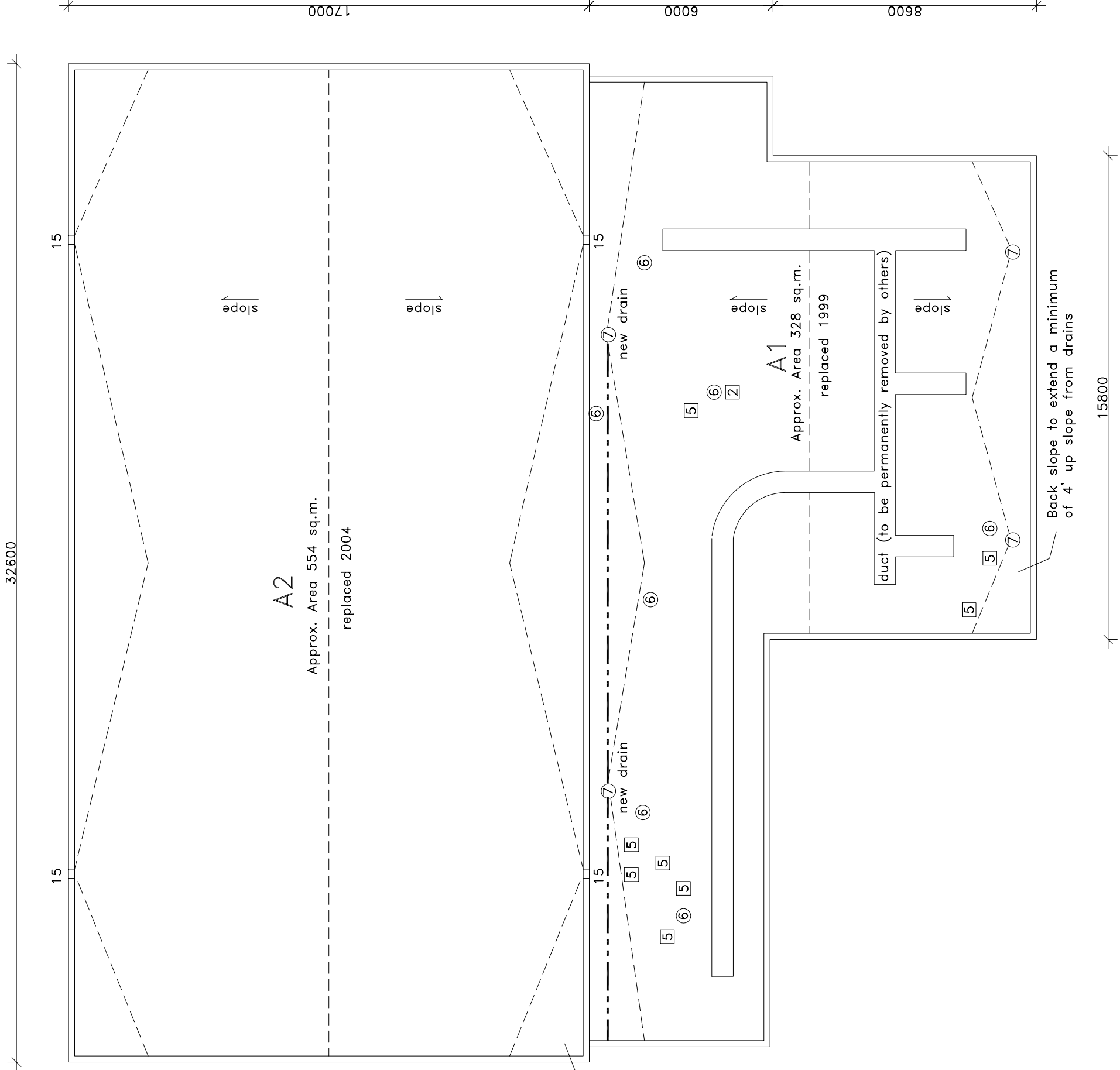

GRAPHIC LEGEND

- Parapet
- Gravel stop
- Control joint
- Expansion joint
- New insulated drain pipe
- Photo vantage point
- Area Label

KEYNOTE LEGEND

- 1 core sample
- 2 chimney
- 3 AC unit
- 4 sign support
- 5 ventilator
- 6 vent pipe
- 7 roof drain
- 8 skylight
- 9 eavestrough
- 10 firewall
- 11 antenna
- 12 ladder
- 13 stub column
- 14 roof hatch
- 15 scupper
- 16 pitch box
- 17 HVAC unit
- 18 capped curb
- 19 flag pole
- 20 electrical mast
- 21 cooling tower
- 22 splash pad
- 23 splash pan
- 24 downspout/rainwater leader
- 25 back slope
- 26 cant
- 27 increase slope to drain
- 28 cricket
- 29 parapet/wide flashing

AGASSIZ CONSULTING GROUP
 809 Pipeline Road, Winnipeg, Manitoba
 Phone: 697-8091 Fax: 697-8039

Project:
Transcona Kinsmen Pool
 1011 Wabasha Street

Date: June 17, 2004
 File no: 3229-04 Scale: 1:150